

Conelock Nut

Thread Type: Metric - Coarse

Thread Direction: Right Hand

Material: Carbon Steel

Class Grade: High Tensile Class 10

Finish: Zinc Plated

Corrosion Protection Level: Moderate

Standard: DIN 980

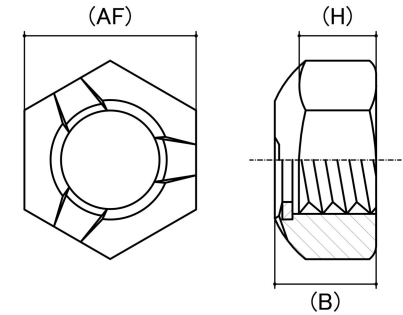

*CAD drawings shown for graphic representation only.**

Size	Thread Pitch (mm)	Thread Type	Overall Nut Height (B) (mm)		Hex Height (H) (mm)	Across Flats (AF) (mm)		Spanner Size (AF) (mm)	sku (qfind)
			Min	Max	Nom	Min	Max		
M6	1.00	Coarse	5.30	6.00	4.50	9.78	10.00	10	41CL6
M8	1.25	Coarse	6.55	8.00	6.00	12.73	13.00	13	41CL8
M10	1.50	Coarse	9.00	10.00	7.50	16.73	17.00	17	41CL10
M12	1.75	Coarse	10.85	12.00	8.50	18.67	19.00	19	41CLM12
M14	2.00	Coarse	12.60	13.60	11.50	21.67	22.00	22	41CL14
M16	2.00	Coarse	14.00	15.50	12.50	23.67	24.00	24	41CL16
M20	2.50	Coarse	18.00	20.00	15.40	29.16	30.00	30	41CL20
M24	3.00	Coarse	21.00	24.00	18.50	35.16	36.00	36	41CL24

Disclaimer:

Dimensional data and technical information was obtained from publically available sources and not acquired through standard agencies. It has been completed and compiled for reference purposes only; where discrepancies are found they are subject to change without notice. Bolt & Nut Australia makes no warranties or representations regarding the accuracy and validity of the compiled information and data. Contact the relevant standard authorities for accurate and detailed information.

* CAD drawings may not reflect diameter, thread length or overall length.

© Bolt & Nut Australia Pty Ltd. All rights reserved.

Version: 18 Mar 2024